

REV.	DESCRIPTION	DATE
A	New Drawing	2013/02/26

Compliance with:
 PCIe4.0(GT/S),
 USB3.2 Gen2(10Gbps),
 USB3.2 Gen2 Type C(10Gbps)
 Mating with:
 "BAAF-040G1145NDLI-B"

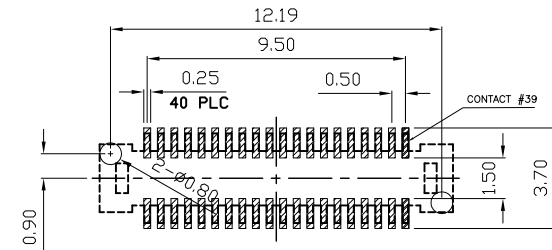
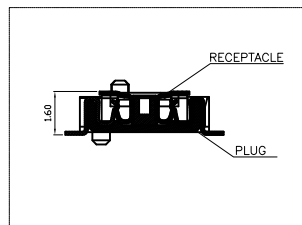
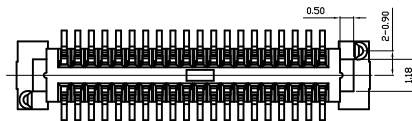
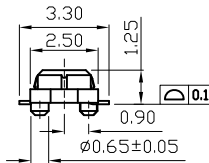
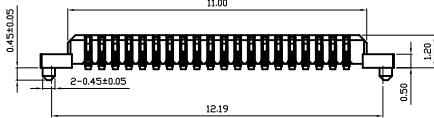
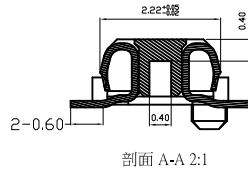
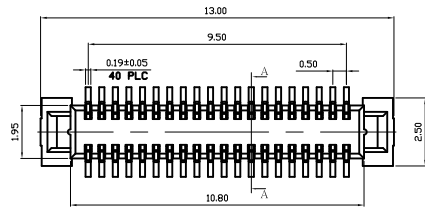

▨ : STAND OFF AREA

P.C.B LAYOUT

RoHS compliant

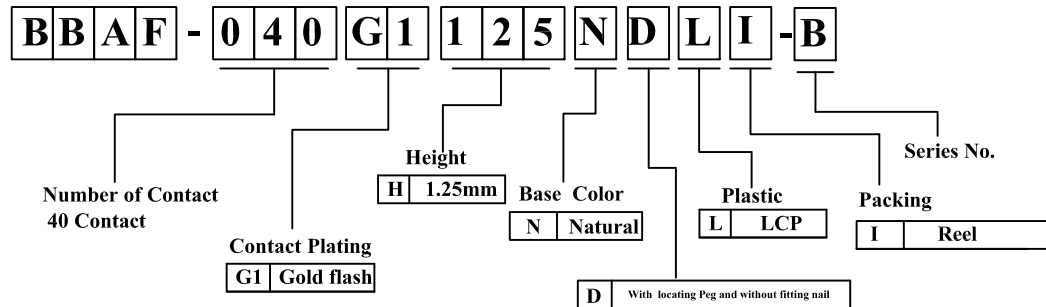

Superior Tech Co., Ltd.

General Tolerance		TITLE	PH0.5 BTOB H1.25 40PIN Male	
X. ± 0.5		DRAWN	DATE	NO.
.X ± 0.3		Tom	02-26-13'	002
.XX ± 0.2		CHECK	DATE	PART NO.
.XXX ± 0.1		APPROVED	DATE	BBAF-040G1125NDLI-B
Angle	± 5°			CUSTOMER NO.

REV.	UNIT	SCALE
A	mm	

