

REV.	DESCRIPTION	DATE
A	New Drawing	2020/10/21

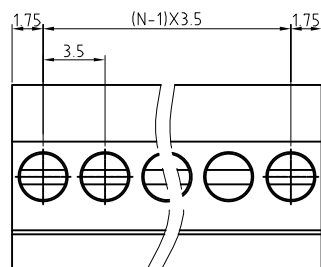
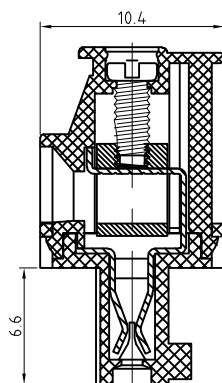
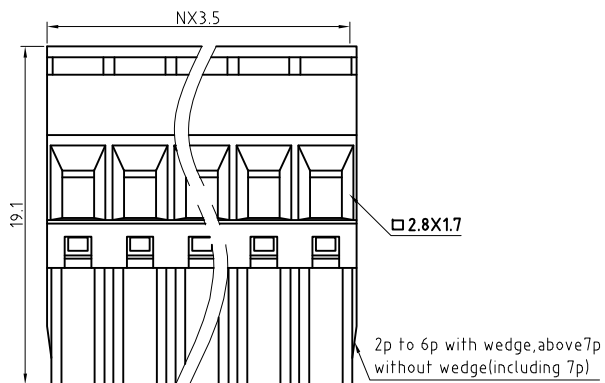
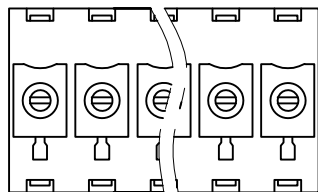

N=Number of contacts

Technical Data:

Material:

Contact (metal housing): Copper Alloy, Ni plated.
Terminal screw: Steel galvanized with Cr3+ plated
Wire guard: Copper Alloy, Tin plated.
Insulator body (housing): Polyamide (UL94V-0)

Electrical

Voltage rating: 300VAC
Current rating: 12 Amps/way max
Contact resistance: 20mΩ (max)
Withstanding Voltage: 2500VAC(1min) Test time=60sec/1pcs
Wire range: 16-24AWG

Mechanical:

Torque: 2.5kgf.cm/M2
Operating temperature: -40°C to +105°C
Soldering reliability:
Test temperature= 250°C±10°C
5 seconds max

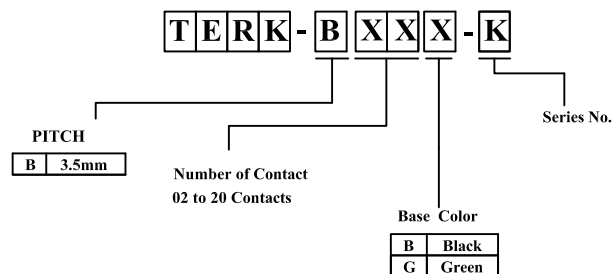

RoHS Compliant

竣豪電子股份有限公司
Superior Tech Co., Ltd.

General Tolerance		TITLE	PH3.5	Terminal Block
X. ± 0.5		DRAWN Annie	DATE	NO.
.X ± 0.3			10-21-20'	T149
.XX ± 0.2		CHECK Annie	DATE	PART NO.
.XXX ± 0.1			10-21-20'	TERK-BXXX-K
角度	± 5°	APPROVED Tom	DATE	CUSTOMER NO.
			10-21-20'	

REV. A	UNIT mm	SCALE N/A	
-----------	------------	--------------	--