

REV.	DESCRIPTION	DATE
A0	New Drawing	2007/1/10

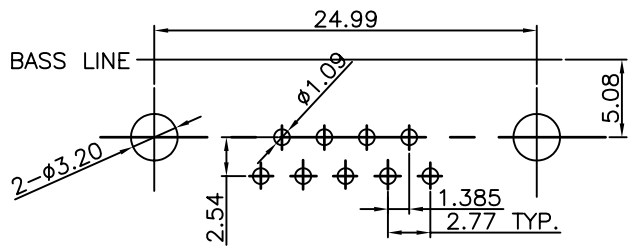
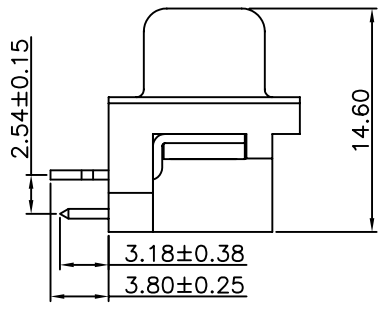
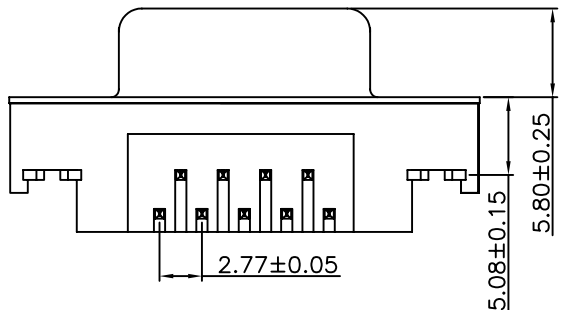
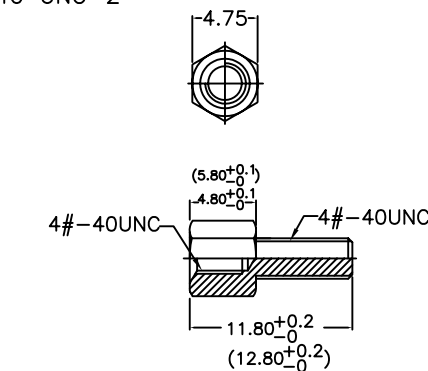
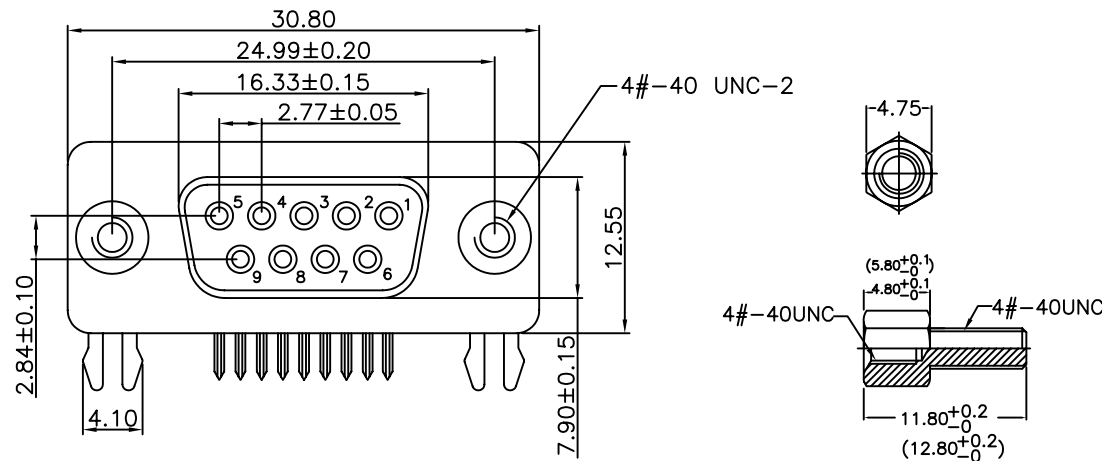

P.C.B LAYOUT

NOTES:

1.MATERIAL

- 1.1 Insulator: PBT+30%Glass Fiber
- 1.2 Contact: Brass
- 1.3 Contact Plated: Gold PLATED OR GOLD/TIN PLATED
- 1.4 Shell: Steel, Nickel plated

2.SPECIFICATION

- 2.1 Current Rate: 5 Amps
- 2.2 Insulator Resistance: 1000 MEGOHMS Min. at 500V DC
- 2.3 Dielectric Strength: 1000V Per minute
- 2.4 Operation Temperature: -55°C to +105°C

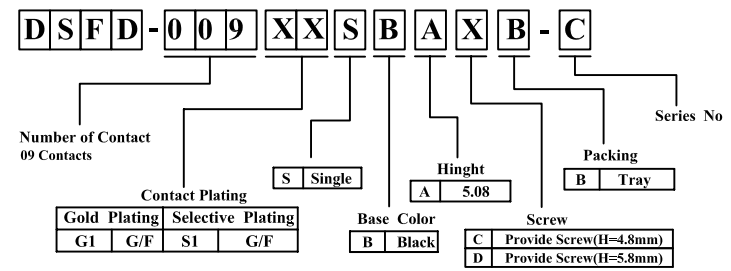

竣豪電子股份有限公司
Superior Tech Co., Ltd.

General Tolerance	TITLE	D-SUB 9母 H5.08mm 90D 附螺絲	
X. ± 0.5	DRAWN	DATE	DWG. NO.
.X ± 0.3	YangFeng	01-10-07'	DSF0019-A
.XX ± 0.2	CHECK	DATE	PART NO.
.XXX ± 0.1	Fuqianshan	01-10-07'	DSFD-009XXSBAXB-C
角度 ± 5°	APPROVE	DATE	CUSTOMET NO.
	YEH	01-10-07'	

REV.	UNIT	SCALE	
A0	mm	2:1	