

REV.	DESCRIPTION	DATE
A	New Drawing	2012/06/26

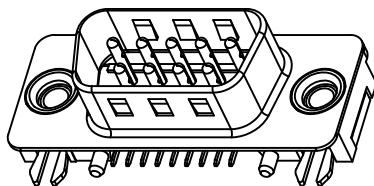
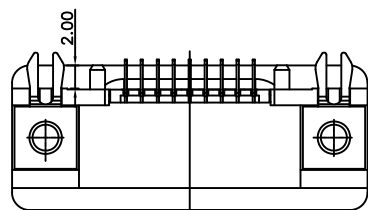
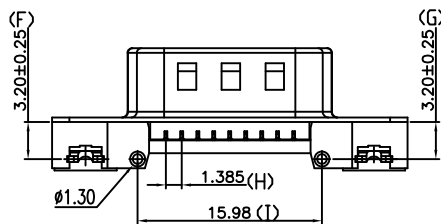
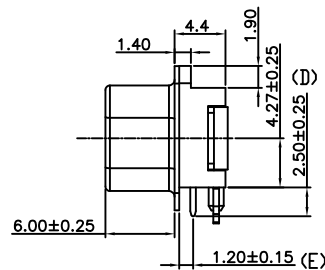
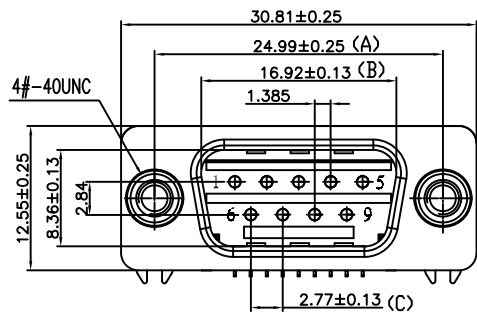

SPECIFICATIONS

- D-SUB
- Voltage: 250 VAC(RMS) Max.
- Current Rating: 3 Ampere per Contact
- Contact Resistance: 25 Milliohms Max.
- Insulation Resistance: 1000 Megohms Min.
- Dielectric Withstanding Voltage: 500V AC(RMS)
- Total Mating Force: 4.0 Kgf Max.
- Total Unmating Force: 1.0 Kgf Min.
- Operating Temperature: -55°C to +85°C

NOTES

- MATERIAL:
Housing:PBT, UL 94V-0, Color:Black.
Terminal:Copper Alloy.
Shell:SPCC.
Boardlock:Copper Alloy.
Rivet:Copper Alloy.
- FINISH:
Terminal:Gold Plated over Nickel at Contact Area.
Tin Plated over Nickel at Solder Area.
Shell:Nickel Plated.
Boardlock:Tin Plated.
Rivet:Nickel Plated.
- This Product is LEAD-FREE & RoHS Compliance Product.

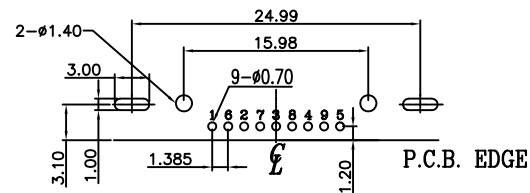

RECOMMENDED P.C.B. LAYOUT
INSPECTION DIMENSION:(A)~(I)

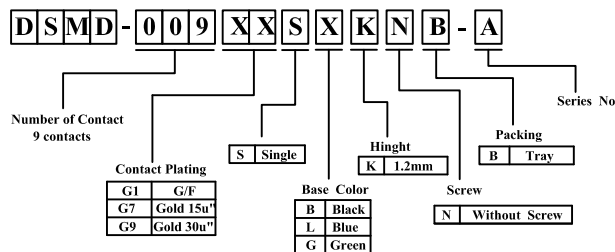

竣豪電子股份有限公司
Superior Tech Co., Ltd.

General Tolerance		TITLE		D-SUB 9公 90度 H1.2 無螺絲	
X. ± 0.5		DRAWN		DATE	
.X ± 0.3		YuHongYu		06-26-12'	
.XX ± 0.2		CHECK		DATE	
.XXX ± 0.1		APPROVED		DATE	
角度	± 5°			DWG. NO. T124	
				PART NO. DSMD-009XXSXKNB-A	
				CUSTOMER NO.	

REV.	UNIT	SCALE	
A	mm	1:1	