

REV.	DESCRIPTION	DATE
A	New Drawing	2011/01/10

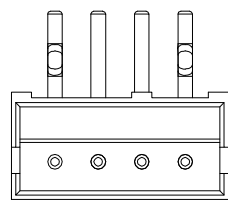

4P(含4P)以下打"K"

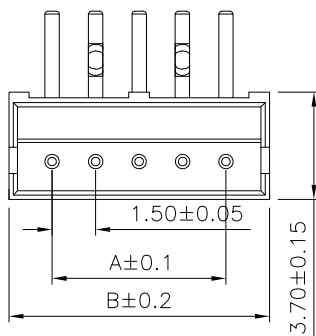

5P(含5P)以上打"K"

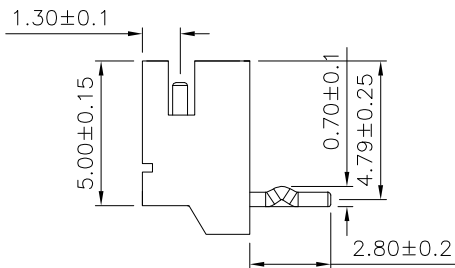
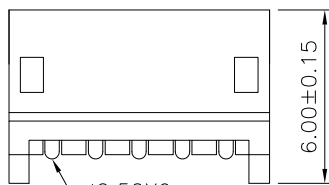
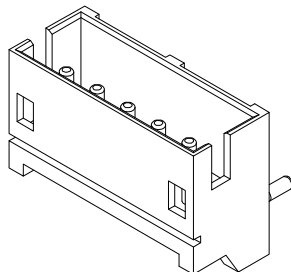

Specifications

Current Rating :1A AC,DC

Voltage rating :100V AC,DC

Temperature range:25°C~+85°C

Contact resistance:20mΩ Max

Insulation resistance:500MΩ Min

Withstanding voltage:500 V AC/minute

Pin Material :Brass

Finished :Tin-plated

Housing Mateial:Nylon-66,UL94V-0

Contact	Dimensions		Contact	Dimensions	
	B	A		B	A
2	4.50	1.50	8	13.50	10.50
3	6.00	3.00	9	15.00	12.00
4	7.50	4.50	10	16.50	13.50
5	9.00	6.00	11	18.00	15.00
6	10.50	7.50	12	19.50	16.50
7	12.00	9.00	13	21.00	18.00

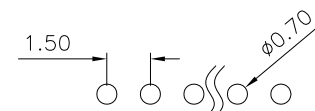
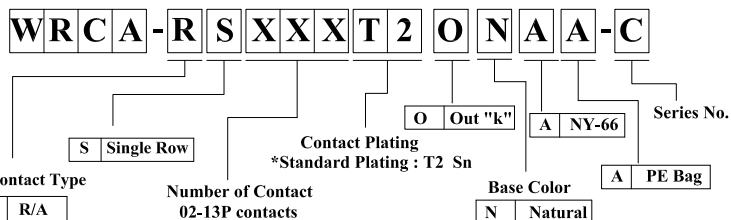

P.C.B LAYOUT

RoHS compliant

竣豪電子股份有限公司
Superior Tech Co., Ltd.

General Tolerance

TITLE

PH1.5 90° WAFER 直徑0.50

X. ± 0.5

DRAWN

DATE

NO.

.X ± 0.3

Zhanghonglan

01-10-11'

T003

.XX ± 0.2

CHECK

DATE

PART NO.

WRCA-RSXXXT2ONAA-C

.XXX ± 0.1

APPROVED

DATE

CUSTOMER NO.

REV.

A

UNIT

mm

SCALE

1:1

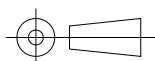

角度

± 5°

(Q2-R03-01A) ST-R05-07