

REV.	DESCRIPTION	DATE
A	New Drawing	2023/11/27

Wafer:WRFB-DSXXXXXNLC-F30
 Wafer:WRFB-RSXXXXXNLC-F30
 Housing:WRFB-H254XXXWAA-F30
 Terminal:CU-PXX-F28

Specifications:
 Current Rating: 3.0A AC,DC
 Voltage Rating: 675V AC,DC
 Contact Resisitance: 20m ohm.Max
 Insulation Resisitance: 1000M ohm.Min
 Withstanding Voltage: 1000V AC/Minute
 Operating Temperature Range: -40°C~+105°C

Material:
 Insulator: Nylon 66(UL94V-0)
 Insulator Color: White

Dimension Information:

Pin.No	Dim.A	Dim.B	Pin.No	Dim.A	Dim.B
2	2.54	6.48	14	33.02	36.96
3	5.08	9.02	15	35.56	39.50
4	7.62	11.56	16	38.10	42.04
5	10.16	14.10	17	40.64	44.58
6	12.70	16.64	18	43.18	47.12
7	15.24	19.18	19	45.72	49.66
8	17.78	21.72	20	48.26	52.20
9	20.32	24.26	21	50.80	54.74
10	22.86	26.80	22	53.34	57.28
11	25.40	29.34	23	55.88	59.82
12	27.94	31.88	24	58.42	62.36
13	30.48	34.42	25	60.96	64.90

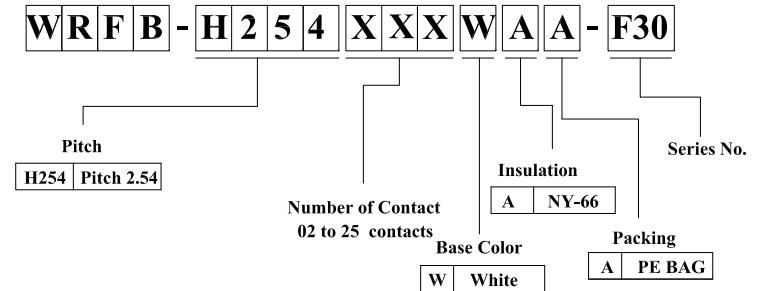
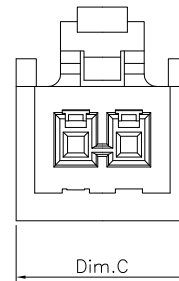
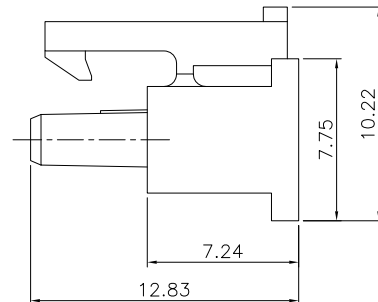
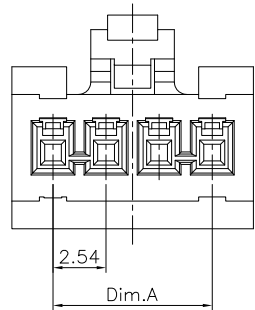
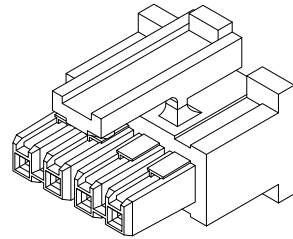
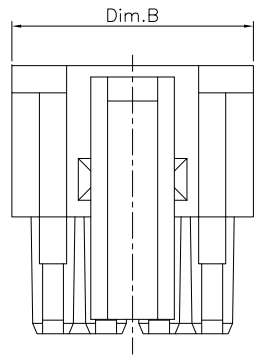

RoHS compliant

竣豪電子股份有限公司
Superior Tech Co., Ltd.

General Tolerance X. ± 0.5 .X ± 0.3 .XX ± 0.2 .XXX ± 0.1 角度 ± 5°	TITLE	PH2.54 Single Row Housing		
	DRAWN	Jacky	DATE	11-27-23'
	CHECK	Tom	DATE	11-27-23'
	APPROVED	Tom	DATE	11-27-23'
	NO.	T230		
	PART NO.	WRFB-H254XXXWAA-F30		
	CUSTOMER NO.			

REV.	UNIT	SCALE	
A	mm	1:1	