

REV.	DESCRIPTION	DATE
A	New Drawing	2019/10/24

Specifications:

Current Rating:9.0A AC/DC
Voltage Rating:600V AC/DC
Contact Resistance:10m ohm. Max.
Insulation Resistance:1000M ohm. Min.
Withstanding Voltage:1500V AC For One Minute
Operating Temperature Range:-40°C To +105°C

Materials:

Insulator:Nylon 66 UL94V-0
Insulator Color:White
Terminal:Brass C2680
Plating:Tin Plated

Housing:WRKD-H420XXXTAA-H-B1
Housing:WRKD-H420XXXWAA-H-B2
Terminal:CU-XT2-H-BX

Housing:WRKD-H420XXXTAA-H-C1
Housing:WRKD-H420XXXWAA-H-C2
Terminal:CU-XT2-H-CX

Wafer:WRKD-DSXXXT2NWAA-H
Wafer:WRKD-DDXXXT2NWAA-H
Wafer:WRKD-RSXXXT2NWAA-H
Wafer:WRKD-RDXXXT2NXAA-H

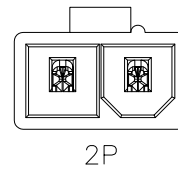
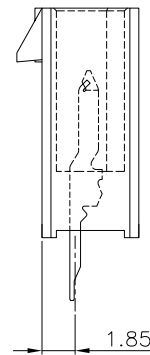
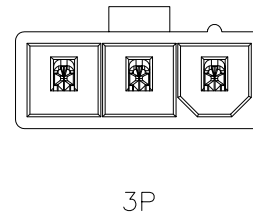
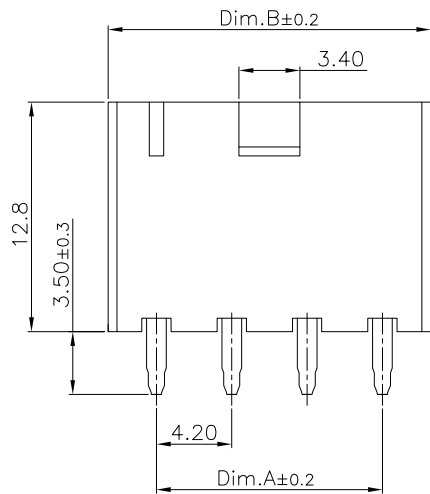
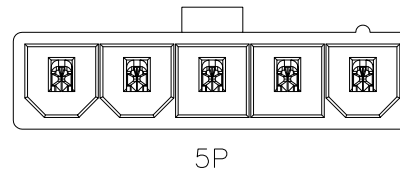
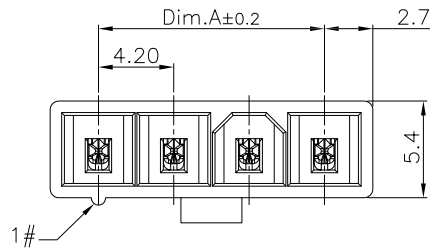

WRKD - D S XXX T 3 N W A A - H

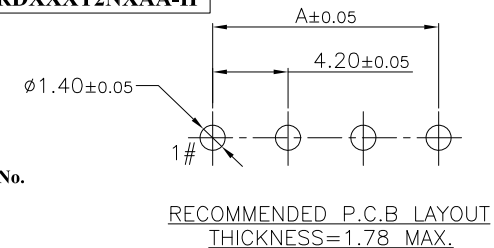
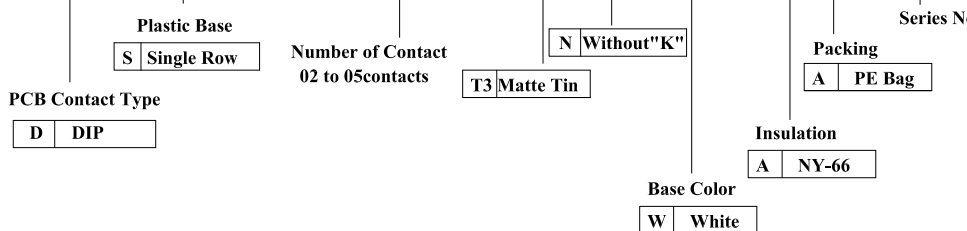

Dimension Information:

Pos.	Dim.A	Dim.B
02	4.20	9.60
03	8.40	13.80
04	12.60	18.00
05	16.80	22.20

RoHS compliant

竣豪電子股份有限公司
Superior Tech Co., Ltd.

General Tolerance		TITLE	Power Wafer PH4.2 Single Row Straight Type(Without post)	
X. ± 0.5		DRAWN	DATE	NO.
.X ± 0.3		Annie	10-24-19'	T230
.XX ± 0.2		CHECK	DATE	PART NO.
.XXX ± 0.1		Annie	10-24-19'	WRKD-DSXXXT3NWAA-H
角度 ± 5°		APPROVED	DATE	CUSTOMER NO.
		Tom	10-24-19'	

REV.	UNIT	SCALE	
A	mm	1:1	