

REV.	DESCRIPTION	DATE
A	New Drawing	2019/10/24

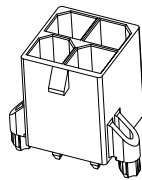

2X2 PIN

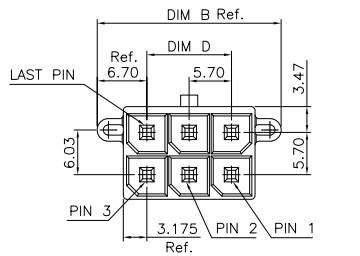
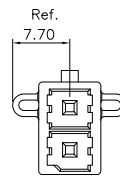

2X1 PIN

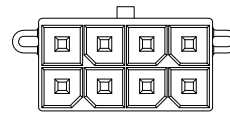

2X4 PIN

Specifications:
 Current Rating:23.0A AC/DC
 Voltage Rating:600V AC/DC
 Contact Resistance:30m ohm. Max.
 Insulation Resistance:1000M ohm. Min.
 Withstanding Voltage:600V AC For One Minute
 Operating Temperature Range:-40°C To +105°C
 Materials:
 Insulator:LCP (UL94V-0)
 Insulator Color:Black
 Contact:Brass
 Plating:Gold or Matte Tin plated
Wafer:WRSD-DDXXXXXXNBLA-H-D
Wafer:WRSD-RDXXXXXXNBLA-H-D
Housing:WRSD-H570XXXBAA-H-D
Terminal:CU-PXX-H-DX

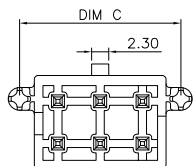
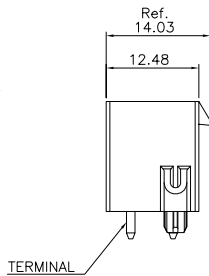
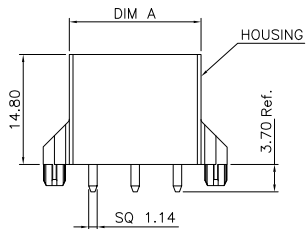

PIN No.	DIM A	DIM B	DIM C	DIM D
2X1	8.35	15.39	12.34	
2X2	12.05	19.10	16.04	5.70
2X3	17.75	24.80	21.74	11.40
2X4	23.45	30.50	27.44	17.10
2X5	29.15	36.20	33.14	22.80
2X6	34.85	41.90	38.84	28.50

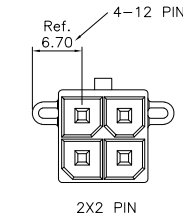

2X2 PIN

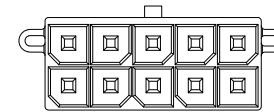

2X5 PIN

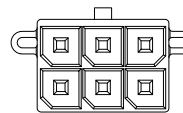

2X3 PIN

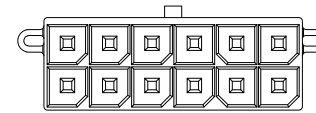

2X6 PIN

WRSD-DDXXXXXXNBLB-H-D

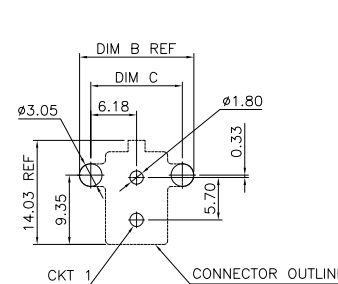
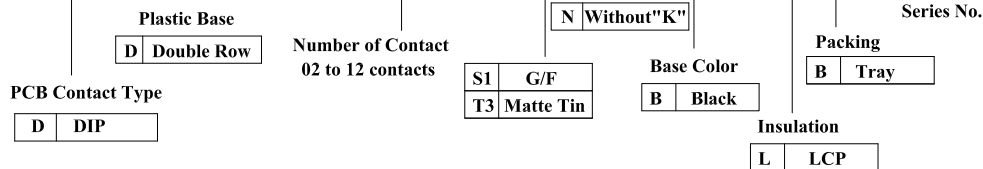

TOLERANCE: ±0.05, THICKNESS: 1.6mm
 RECOMMENDED PCB LAYOUT
 (TOP VIEW)

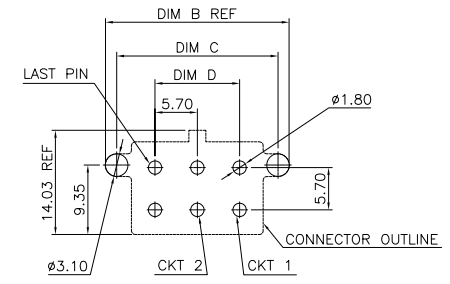

TOLERANCE: ±0.05, THICKNESS: 1.6mm
 RECOMMENDED PCB LAYOUT
 (TOP VIEW)

RoHS compliant

竣豪電子股份有限公司
Superior Tech Co., Ltd.

REV.	UNIT	SCALE	1:1		General Tolerance	TITLE Power Wafer PH5.7 Double Row Straight Type		
					X. ± 0.5	DRAWN	DATE	NO.
					.X ± 0.3	Annie	10-24-19'	T230
					.XX ± 0.2	CHECK	DATE	PART NO.
					.XXX ± 0.1	Annie	10-24-19'	WRSD-DDXXXXXXNBLB-H-D
角度	± 5°	APPROVED	DATE	CUSTOMER NO.	Tom	10-24-19'		