

REV.	DESCRIPTION	DATE
A	New Drawing	2017/04/06

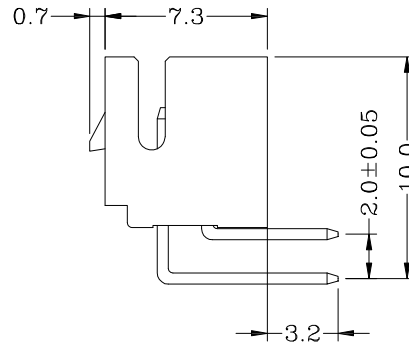
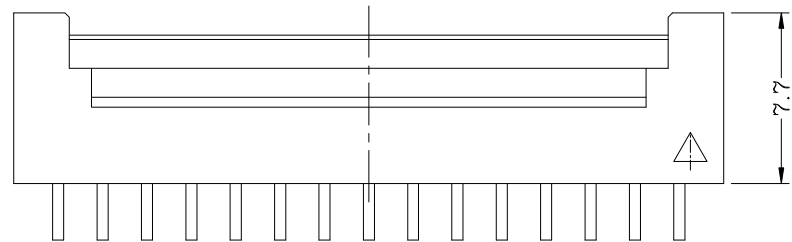
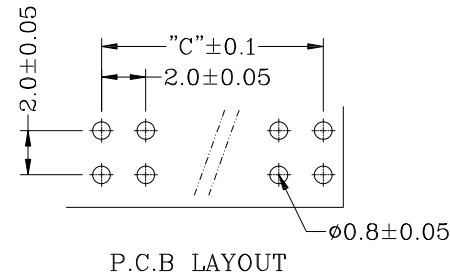
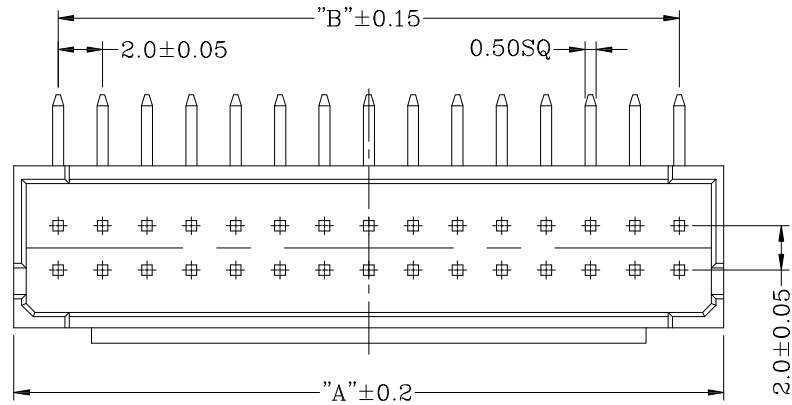

■ 技术参数 SPECIFICATIONS

- ◆ 额定电压: 250V DC/AC
Rated voltage: 250V DC/AC
- ◆ 额定电流: 3A DC/AC
Rated Current: 3A DC/AC
- ◆ 耐压值: 1000V AC/minute
Withstand voltage: 1000V AC
- ◆ 工作温度: -25° C ~ +85° C
Working Temperature: -25° C
- ◆ 绝缘电阻: ≥1000 MΩ
Insulation resistance: ≥10
- ◆ 接触电阻: ≤30mΩ
Contact resistance: ≤30mΩ

■ 材料 MATERIAL

- ◆ 塑胶: 尼龙46(Nylon46) , UL
- ◆ PIN针: 黄铜(Brass)

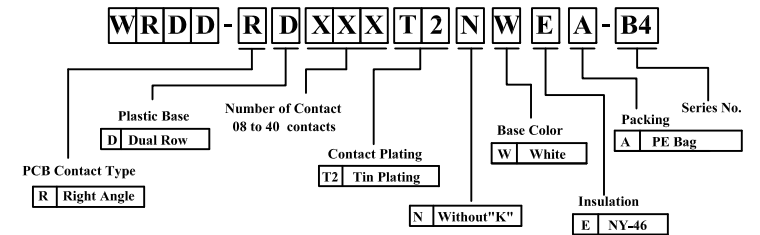

	2x4P	2x5P	2x6P	2x7P	2x8P	2x9P	2x10P	2x11P	2x12P	2x13P	2x14P	2x15P	2x16P	2x17P		2x19P	2x20P
A	10.0	12.0	14.0	16.0	18.0	20.0	22.0	24.0	26.0	28.0	30.0	32.0	34.0	36.0		40.0	42.0
B	6.0	8.0	10.0	12.0	14.0	16.0	18.0	20.0	22.0	24.0	26.0	28.0	30.0	32.0		36.0	38.0

RoHS compliant

竣豪電子股份有限公司
Superior Tech Co., Ltd.

General Tolerance

TITLE

2.0mm Crimp Style connectors

X. ± 0.5

DRAWN

DATE

NO.

.X ± 0.3

Andy

04-06-17'

T134

.XX ± 0.2

CHECK

DATE

PART NO.

WRDD-RDXXXT2NWEA-B4

.XXX ± 0.1

APPROVED

DATE

CUSTOMER NO.

REV.

A

UNIT

mm

SCALE

1:1

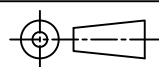

角度

± 5°